

c`go & c`go up Active

Save and get started

The c'go and c'go up caravans offer comprehensive equipment at a special price with the ACTIVE package. Whether for weekend getaways or extended family holidays, the c'go adapts to all needs. You will immediately feel at home in the inviting and bright interior. Whether you are looking for a compact model for spontaneous trips or a spacious family caravan, our clever space solutions are just right for you. Families in particular will love the c'go up 525 KR – with the pull-down bed in the rear, there is more space to live despite the compact dimensions.

Upholstery

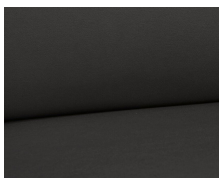

+ Upholstery
Granada



+ Upholstery
Estepona ○



+ Upholstery
Manilva ○

Wood décor



+ WEB Alaska White

○ optionally available

Technical info

Overall length, approx.	676 - 756 cm
Overall width, approx.	233 cm
Overall height, approx.	261 - 271 cm
Headroom in living area, approx.	198 - 208 cm

Maximum values partly not possible for all models or only in connection with certain options.

Plus factors

- + Ready to go! Experience the perfect combination of comfort and affordability with the new c'go and g'go up ACTIVE.
- + Cosy interior: New upholstery and furniture details create a pleasant and modern atmosphere.
- + Clever pull-down bed: The c'go up ACTIVE impresses with a standard pull-down bed (200 x 140 cm lying surface) above the seating area.
- + Protects you from bad weather: roof, front and rear made of robust GRP
- + Guaranteed tightness for 10 years: Regular leak tests ensure your vehicle is reliably protected in all weather conditions.



c`go & c`go up Active

Technical info

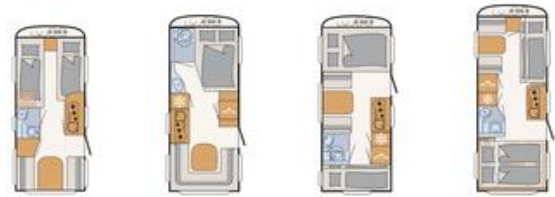

c`go & c`go up Active		475 EL	495 FR	495 QSK	up 525 KR
Standard chassis		Lightweight chassis, 1300 kg	Lightweight chassis, 1360 kg	Lightweight chassis, 1360 kg	Lightweight chassis, 1600 kg
Overall length, approx.	cm	676	725	714	756
Body length approx.	cm	552	588	587	623
Overall width, approx.	cm	233	233	233	233
Overall height, approx.	cm	261	261	261	271
Circumferential dimension awning approx.	cm	955	992	990	1040
Headroom in living area, approx.	cm	198	198	198	208
Thickness floor / side walls / roof	mm	38 / 28 / 28	38 / 28 / 28	38 / 28 / 28	38 / 28 / 28
Tire size		185 R14C 8PR	185 R14C 8PR	185 R14C 8PR	185 R14C 8PR
Bed dimension: Front bed, L x W, approx.	cm	210 x 85 / 185 x 85 / 200 x 190 ○	200 x 145 - 110	210 x 135	205 x 75 / 200 x 75 / 175 x 90 - 80
Bed dimension: Central / middle bed, L X W, approx.	cm	—	—	190 x 90	—
Bed dimension: Rear bed, L x W, approx.	cm	210 x 105	210 x 150 - 130	2x 210 x 75 / 3x 210 x 75 ○	200 x 145 / 212 x 170 - 160
Sleeping berths standard / max.		3	4	5 / 6 ○	7
Mass in running order (+/-5%)*	kg	1130 (1074 to 1187)*	1135 (1078 to 1192)*	1165 (1107 to 1223)*	1341 (1274 to 1408)*
Manufacturer-specified mass for optional equipment*	kg	79	118	67	117
Technically permissible maximum laden mass*	kg	1300	1360	1360	1600
Heating		S 3004, 3.5 kW Gas	S 3004, 3.5 kW Gas	S 3004, 3.5 kW Gas	S 3004, 3.5 kW Gas
Refrigerator volume (thereof freezer), approx.	l	78 (11)	137 (15)	137 (15)	137 (15)
Waste water tank, approx.	l	23	23	23	23
Fresh water tank capacity, total/ Fresh water tank capacity at driving filling	l	44 / 15	44 / 15	44 / 15	44 / 15
Sockets: 12 V / 230 V / USB		0 / 5 / 0	0 / 5 / 0	0 / 5 / 0	0 / 6 / 0

○ Optional equipment — Not possible ● Standard equipment ◆ Mandatory △ Not known at the time of publication



* INFO

The specified mass in running order is a standard value defined in the type approval procedure. Due to manufacturing tolerances, the actual weighed mass in running order may deviate from the value stated above. Deviations of up to ± 5% of the mass in running order are legally permissible and possible. The permissible range in kilograms is stated in parentheses after the mass in running order. The mass for optional equipment specified by the manufacturer is an imputed value determined for each type and layout by which Dethleffs specifies the maximum weight available for factory-fitted optional equipment. The purpose of limiting optional equipment is to ensure that the minimum payload, i.e. the legally required free mass for baggage and retrofitted accessories, is actually available for the load capacity of vehicles delivered by

Dethleffs. The actual weight of your vehicle after leaving the factory can only be determined when it is weighed at the end of the line. If, in exceptional cases, the weighing shows that the actual load capacity falls short of the minimum payload due to a permissible weight deviation, despite the limitation of the optional equipment, we will check together with your trading partner and you before delivery of the vehicle whether we should, for example, increase the load capacity of the vehicle or remove optional equipment. The technically permissible maximum laden mass of the vehicle must not be exceeded. For detailed information and explanations on the topic of weight and the configuration of the vehicle, please refer to the "Legal notes" section.

Standard equipment

	475 EL	495 FR	495 QSK	up 525 KR
Chassis				
Single-axle, tyres on steel rims 185 R14 C 8 PR, up to and including 1600 kg	●	●	●	●
Zinc-plated chassis with inertia braking system with reversing automatic	●	●	●	●
Chassis features				
AAA self-adjusting brake	—	—	—	●
ACS stabiliser	●	●	●	●
High-quality brand-name tyres, designed for a speed of 100 km/h	●	●	●	●
Lightweight zinc-plated corner steadies	●	●	●	●
Octagon shock absorber	●	●	●	●
Exterior features				
Floor of the gas bottle locker made of rot-resistant and robust corrugated aluminium	●	●	●	●
Front, rear and roof made of robust GRP	●	●	●	●
One-piece habitation door	●	●	●	●
Opening windows, trapezoid, insulated and double-glazed (graphite grey) with blackout and mosquito blinds	●	●	●	●
Skylight Mini Heki	●	●	●	●
Spare wheel carrier in gas locker	●	●	●	●
Storage space for 2 gas bottles with 11 kg filling weight each	●	●	●	●
Exterior design				
Sides in hammer finish, white	●	●	●	●
Access locker doors				
Access locker door front right side 1000x420 mm	●	●	●	—
Access locker door front right side 997x419 mm	—	—	—	●
Interior design				
Upholstery Granada	●	●	●	●
WEB Alaska White	●	●	●	●
Textile equipment				
7-zones cold foam mattress single bed, left side, standard	●	—	—	—
7-zones cold foam mattress single bed, right side, standard	●	—	—	—
Cold foam double bed mattress	—	●	●	●
Furniture layouts				
AirPlus - perfect air circulation in the interior and rear ventilation of the overhead lockers and sideboards	●	●	●	●
Bunk bed with 2 sleeping berths, foldable	—	—	●	●
Bunk beds with safety net and ladder	—	—	●	●
Seating lounge converts to bed	●	●	●	●
Spacious pull-down bed above seating lounge, with manual control	—	—	—	●
Special slatted frame with flexible natural rubber holders, opening for optimal use of storage compartments under the beds	●	●	●	●
Interior features				
Smoke detector	●	●	●	●
Kitchen				
Generous drawers with soft closing for absolutely silent closing	●	●	●	●
Large fridge with 137 liters capacity and 15 liters freezer compartment	—	●	●	●
Practical 3-flames cooker with electric ignition	●	●	●	●
Spacious fridge with 78 liters volume and 11 liters freezer compartment	●	—	—	—
Bathroom				
Shapely washbasin	●	●	●	●
Shower tray	●	●	●	●
Skylight with mosquito net	●	●	●	●
Heating				
Gas heating S 3004 with automatic ignition	●	●	●	●
Electrical installation				

Standard equipment

	475 EL	495 FR	495 QSK	up 525 KR
12 V power supply throughout vehicle	●	●	●	●
Additional lighting through LED spotlights	●	●	●	●
Awning light 12V	●	●	●	●
CEE external output socket for 230V on-board electrics	●	●	●	●
Compact power distribution unit with 230V safety device and 12V fuse box in wardrobe incl. powerful 340W transformer	●	●	●	●
LED spots in front and rear seating lounges	●	●	●	●
Water supply				
Electric water supply	●	●	●	●
Fresh water tank 44 l	●	●	●	●
Mobile 22 l waste water tank	●	●	●	●
Miscellaneous				
Dethleffs Connect - System Information Unit: SIU control unit incl. voltage and levelling display via the Dethleffs app.	●	●	●	●

Packages c`go & c`go up Active

Package	Active-Paket 475 EL (15501)	Active-Paket 495 FR (15502)	Active package 495 QSK (15503)	Active package up 525 KR (15504)
Tyres on alloy wheels 195 R14 C LI106, 1700 kg and 1800 kg	x	x	x	x
Weight upgrade 1.700 kg (incl. steel wheel 195 R14 C LI106)	x			
Corner steadies incl. large-area support feet	x	x	x	x
Heki II skylight incl. illuminated roof lining	x	x	x	x
Flyscreen door	x	x	x	x
Kitchen window, sliding (change of window shape)	x			x
7-zones mattress, made of heat-regulating material	x	x	x	x
Single beds convert to double bed	x			
Hot air system	x	x	x	x
Indirect lighting	x	x	x	x
USB port for spotlight bar	x	x	x	x
Pre-wiring for A/C	x	x	x	x
Hot water supply	x	x	x	x
Weight upgrade 1.700 kg (incl. steel wheel 195 R14 C LI106)		x		
Weight upgrade 1.700 kg (incl. steel wheel 195 R14 C LI106)			x	
Weight upgrade 1.800 kg (incl. steel wheel 195 R14 C LI106)				x
Additional weight (kg)*	70	69	41	36

Package	Safety Package (9556)	Safety Package (9556)
ATC Trailer Control	x	x
DuoControl safety gas pressure regulator with crash sensor	x	
Automatic gas cylinder changeover with crash sensor and gas regulator heating EisEx		x
Additional weight (kg)*	4.4	4.4

Package	Autonomy Package I (10011)	Autonomy Package II (10012)
Battery (95 Ah)	x	x
Battery charger	x	x
Central 12V main switch	x	x
Voltage display	x	x
Fan 12V for S 3004	x	
Additional weight (kg)*	31	29

△ Not known at the time of publication



* INFO

The factory installation of optional equipment increases the actual mass of the vehicle and reduces the payload. The specified additional weight for packages and optional equipment shows the additional weight compared with the standard equipment of the respective model or layout. The total weight of the selected optional equipment must not exceed the mass for optional equipment specified by the manufacturer in the model overviews. This is an imputed

value determined for each model and layout that Dethleffs uses to determine the maximum weight available for factory-installed optional equipment. In the event of an increase of load capacity, the mass for optional equipment specified by the manufacturer is increased. For detailed information and explanations on the topic of weight, please refer to the "Legal notes" section.

Optional equipment**

	Included in package	Additional weight (kg)*	Code	475 EL	495 FR	495 QSK	up 525 KR
Chassis							
17" alloy wheels in Dethleffs design (single axle)	—	1	11608	○	○	○	○
Tyres on alloy wheels 185 R14 C LI102, up to and including 1600 kg	—	1	836	○	○	○	○
Tyres on alloy wheels 195 R14 C LI106, 1700 kg and 1800 kg	AC-P	1	838	○	○	○	○
Weight upgrade							
Weight upgrade 1.700 kg (incl. steel wheel 195 R14 C LI106)	AC-P	36	278	○	—	—	—
Weight upgrade 1.700 kg (incl. steel wheel 195 R14 C LI106)	AC-P	44	278	—	○	—	—
Weight upgrade 1.700 kg (incl. steel wheel 195 R14 C LI106)	AC-P	16	278	—	—	○	—
Weight upgrade 1.800 kg (incl. steel wheel 195 R14 C LI106)	AC-P	8	279	—	—	—	○
Weight upgrade to 1.360 kg (without chassis change)	—	0	9619	○	—	—	—
Weight upgrade to 1.400 kg	—	38	359	—	○	—	—
Weight upgrade to 1.400 kg	—	0	359	○	—	○	—
Weight upgrade to 1.500 kg	—	0	136	○	—	○	—
Weight upgrade to 1.500 kg	—	38	136	—	○	—	—
Chassis features							
ATC Trailer Control	SHP	4	748	○	○	○	○
Corner steadies incl. large-area support feet	AC-P	4	9138	○	○	○	○
Draw bar cover	—	2	434	○	○	○	○
Solid rubber support wheel with support load indicator	—	2	10063	○	○	○	○
Spare tyre with alloy wheel 185 R14 C LI 102, up to and including 1.600 kg	—	17	837	○	○	○	○
Spare tyre with alloy wheel 195 R14 C 8PR-LI 106, 1.700 kg and 1.800 kg	—	18.8	839	○	○	○	○
Spare tyre with alloy wheel 215/60 R17 C LI 109	—	24.1	11540	○	○	○	○
Spare tyre with steel wheel 185 R14 C 8 PR, up to and including 1.600 kg	—	18	831	○	○	○	○
Spare tyre with steel wheel 195 R14 C LI 106, 1.700 kg and 1.800 kg	—	20.4	833	○	○	○	○
Wheel trims for 14" tyres	—	0.5	276	○	○	○	○
Exterior features							
Flyscreen door	AC-P	3	360	○	○	○	○
Front window	—	3	982	○	○	○	—
Heki II skylight incl. illuminated roof lining	AC-P	10	274	○	○	○	○
Kitchen window, sliding (change of window shape)	AC-P	3	6406	○	○	○	○
One-piece habitation door with window	—	0	6427	—	—	—	○
Opening window in bathroom	—	2	1028	○	○	○	○
Exterior design							
Smooth sides white	—	17	443	○	—	—	—
Smooth sides white	—	17	443	—	○	○	○
Access locker doors							
Access locker door front left side 1000x420 mm	—	2	6415	○	—	○	—
Access locker door front right side 1675x885 mm	—	0	9430	—	—	—	○
Access locker door rear left side 749x297 mm	—	2	1077	—	—	—	○
Access locker door rear right side 749x297 mm	—	2	1078	—	—	—	○
Access locker door rear right side 750x300 mm	—	2	6422	—	○	—	—
Interior design							
Upholstery Estepona	—	0	13901	○	○	○	○
Upholstery Manilva	—	0	13902	○	○	○	○



* INFO

The factory installation of optional equipment increases the actual mass of the vehicle and reduces the payload. The specified additional weight for packages and optional equipment shows the additional weight compared with the standard equipment of the respective model or layout. The total weight of the selected optional equipment must not exceed the mass for optional equipment specified by the manufacturer in the model overviews. This is an imputed

value determined for each model and layout that Dethleffs uses to determine the maximum weight available for factory-installed optional equipment. In the event of an increase of load capacity, the mass for optional equipment specified by the manufacturer is increased. For detailed information and explanations on the topic of weight, please refer to the "Legal notes" section.

Optional equipment**

	Included in package	Additional weight (kg)*	Code	475 EL	495 FR	495 QSK	up 525 KR
Textile equipment							
7-zones mattress, made of heat-regulating material	AC-P	0	10318	○	○	○	○
Loose carpet	—	7	513	○	○	○	○
Furniture layouts							
Bunk bed with 3 sleeping berths, not foldable	—	21	200	—	—	○	—
Hanging table with rotating device	—	0	8699	—	—	○	—
Seat enlargement for opposite seating lounge (in comb. with option 8699) ²⁾	—	0	7750	—	—	○	—
Single beds convert to double bed	AC-P	6	685	○	—	—	—
Multimedia							
Multifunctional external connection, 12 V, 220 V, TV and SAT ³⁾	—	1	611	○	○	○	○
Preparation for flat screen TV (antenna cable and TV bracket)	—	2	678	○	○	○	○
Heating							
Electric floor heating	—	6	387	○	○	○	○
Fan 12V for S 3004	AP	2	177	○	○	○	○
Hot air system	AC-P	0	142	○	○	○	○
Ultraheat additional heating for S 3004, electric 220 V	—	2	364	○	○	○	○
Air Conditioning							
Pre-wiring for A/C	AC-P	3.5	172	○	○	○	○
Electrical installation							
Indirect lighting	AC-P	1	633	○	○	○	○
USB port for spotlight bar	AC-P	0.5	9989	○	○	○	○
Water supply							
City water connection	—	2	414	—	—	—	○
Hot water supply	AC-P	2	123	○	○	○	○
Shower equipment with shower fittings and curtain	—	3	1097	○	○	○	○
Gas supply							
Automatic gas cylinder changeover with crash sensor and gas regulator heating EisEx	SHP	0.4	784	—	—	—	○
DuoControl safety gas pressure regulator with crash sensor	SHP	0.4	784	○	○	○	○
Gas socket (exterior) ⁴⁾	—	1	187	○	○	○	○
Packages							
Active package 495 QSK	—	41	15503	—	—	○	—
Active package up 525 KR	—	36	15504	—	—	—	○
Active-Paket 475 EL	—	70	15501	○	—	—	—
Active-Paket 495 FR	—	69	15502	—	○	—	—
Autonomy Package I	—	31	10011	○	○	○	○
Autonomy Package II	—	29	10012	○	○	○	○
Safety Package	—	4.4	9556	○	○	○	—
Safety Package	—	4.4	9556	—	—	—	○
Miscellaneous							
Registration documents (CoC papers)	—	0	15151	◆	◆	◆	◆

○ Optional equipment — Not possible ● Standard equipment ◆ Mandatory △ Not known at the time of publication

AC-P Active Package SHP Safety Package AP Autonomy Package



* INFO

The factory installation of optional equipment increases the actual mass of the vehicle and reduces the payload. The specified additional weight for packages and optional equipment shows the additional weight compared with the standard equipment of the respective model or layout. The total weight of the selected optional equipment must not exceed the mass for optional equipment specified by the manufacturer in the model overviews. This is an imputed

value determined for each model and layout that Dethleffs uses to determine the maximum weight available for factory-installed optional equipment. In the event of an increase of load capacity, the mass for optional equipment specified by the manufacturer is increased. For detailed information and explanations on the topic of weight, please refer to the "Legal notes" section.

LEGAL NOTES ON WEIGHT-RELATED INFORMATION

The weight specifications and tests for caravans are regulated uniformly throughout the EU in EU Implementing Regulation No. 2021/535 (until June 2022: EU Regulation No. 1230/2012). We have summarized and explained the essential terminology and legal requirements from this regulation for you below. Our dealers and the Dethleffs configurator on our website are there to give you additional assistance in configuring your vehicle.

1. Technically permissible maximum laden mass

The **technically permissible maximum laden mass** of the vehicle (e.g. 2,000 kg) is a mass specification defined by the manufacturer that the vehicle must not exceed. You can find information on the technically permissible maximum laden mass of the model you have selected in the technical data. Driving the vehicle even if it exceeds the technically permissible maximum laden mass constitutes an administrative offense that may result in a fine.

2. Mass in running order

In simple terms, the mass in running order is the basic vehicle with standard equipment. This essentially includes the following items:

- the unladen weight of the vehicle together with the bodywork, including operating fluids;
- the standard equipment, i.e. all equipment and standard fittings included when the vehicle leaves the factory;
- the 100% filled water tank or drinking tank according to the manufacturer's specifications and a 100% filled aluminum gas cylinder.

You can find information on the mass in running order for each model in our sales documents. It is **important to note** that the value specified in the sales documents for the mass in running order is a **standard value** determined in the type approval process and verified by the authorities. It is legally permissible and possible for the mass in running order of the vehicle delivered to you to deviate from the nominal value specified in the sales documents. The **legally permissible tolerance** is $\pm 5\%$. This allows EU legislation to account for the occurrence of certain fluctuations in the mass in running order due to weight fluctuations in components supplied by third-party suppliers as well as process and weather-related factors.

These weight deviations can be illustrated using the following example calculation:

- Mass in running order according to sales documents: 1,600 kg
- Legally permissible tolerance of $\pm 5\%$: 80 kg
- Legally permissible range of mass in running order: 1,520 kg to 1,680 kg

The specific range of permissible weight deviations can be found in the technical data for each model.

Dethleffs makes great efforts to reduce weight variations to the minimum level that is unavoidable for production reasons. Deviations at the upper and lower ends of the range are therefore very rare; however, they cannot be completely ruled out technically, even after carrying out all possible optimization measures. For this reason, Dethleffs checks the actual weight of the vehicle and compliance with the permissible tolerance by weighing each vehicle at the end of the line.

3. Optional equipment and actual mass

According to the legal definition, optional equipment (also including special or additional equipment) includes all optional equipment parts not included with the standard equipment that are fitted to the vehicle under the responsibility of the manufacturer – i.e. at the factory – and can be ordered by the customer (e.g. awning, smooth panel, Alde heating system, oven, etc.). For information on the individual or package weights of the optional equipment that can be ordered, please refer to our sales documents. In this meaning, optional equipment does not include other accessories that are retrofitted by you or your dealer personally after the vehicle has been delivered from the factory.

The mass of the vehicle in running order (see no. 2 above) and the mass of the optional equipment installed on a specific vehicle at the factory are together referred to as the actual mass. You will find the corresponding information for your vehicle after handover under item 13.2 of the Certificate of Conformity (CoC). Please note that this information also represents a standardized value. Since the mass in running order – as an element of the actual mass – is subject to a legally permissible tolerance of $\pm 5\%$ (see no. 2), the actual mass may also deviate accordingly from the specified nominal value.

4. Payload and minimum payload

The installation of **optional equipment** is also subject to technical and legal limits: It is only permissible to order an amount of optional equipment for installation at the factory that will leave sufficient free weight for baggage and other accessories (i.e. "payload") without exceeding the technically permissible maximum laden mass.

The payload is obtained by deducting the mass in running order (nominal value according to sales documents; see no. 2 above) and the mass of the optional equipment from the technically permissible maximum laden mass (see no. 1 above). The EU regulations stipulate a fixed minimum payload for caravans that must remain as a minimum for baggage or other accessories not installed at the factory. This minimum payload is calculated as follows:

Minimum payload in kg $\geq 10 \cdot (n + L)$

where "n" = maximum number of sleeping berths and

"L" = total length of the vehicle body (without drawbar).

The maximum number of sleeping berths corresponds to the actual configured sleeping berths of the individual vehicle. For a caravan with 6 designated sleeping berths and a total length of the vehicle body of 7 m, the minimum payload is calculated as follows: $10 \text{ kg} \cdot (6 + 7) = 130 \text{ kg}$.

To ensure that the minimum payload is maintained, there is a maximum combination of optional equipment that can be ordered for each vehicle model. In the above example with a minimum payload of 130 kg, the total mass of the optional equipment for a vehicle with 6 designated sleeping berths and a mass in running order of 1,750 kg should not exceed 120 kg:

2,000 kg technically permissible maximum laden mass

- 1,750 kg mass in running order
- 130 kg minimum payload
- = **120 kg maximum permissible mass for optional equipment**

It is important to note that this calculation is based on the standard value for the mass in running order specified in the type approval procedure and does not account for permissible weight deviations for the mass in running order (see no. 2 above). If the maximum permissible value of 120 kg for the optional equipment is nearly or fully exhausted in this example and the standard value of the mass in running order is applied, it is possible for the minimum payload of 130 kg to be complied with mathematically in the event of an upward weight deviation even if the vehicle has no load capacity.

Here is another example calculation for a vehicle with 6 sleeping berths whose actual weighed mass in running order is 2% above the nominal value:

2,000 kg technically permissible maximum laden mass

- 1,785 kg actual weighed mass in running order
(in the example: 2% higher than the specified value of 1,750 kg)
- 120 kg optional equipment (maximum permissible value)
- = **95 kg actual load capacity**
($<$ minimum pay-mass of 130 kg)

To avoid such a situation, Dethleffs further reduces the maximum permissible weight of the total optional equipment that can be ordered depending on the specific model. The limitation of optional equipment is intended to ensure that the minimum payload, i.e. the legally prescribed free mass for baggage and retrofitted accessories, is actually available for the load capacity of the vehicles delivered by Dethleffs.

Since the weight of a specific vehicle can only be determined when it is weighed at the end of the line, in very rare cases a situation may arise in which the minimum payload is not guaranteed at the end of the line despite this limitation of optional equipment. In order to guarantee the minimum payload even in these cases, Dethleffs will check together with your trading partner and you before delivery of the vehicle whether, for example, the load capacity of your vehicle is to be increased or optional equipment removed.

5. Effects of tolerances of the mass in running order on the remaining load capacity

Irrespective of the minimum payload, you should bear in mind that unavoidable production-related fluctuations in the mass in running order – both upwards and downwards – have a corresponding effect on the remaining load capacity: If, for example, you order our example vehicle with optional equipment with a total weight of 90 kg, the calculated payload based on the standard value for the mass in running order is 160 kg.

The load capacity actually available may deviate upwards or downwards from this value due to tolerances. If the mass of your vehicle in running order is approximately 2% higher than specified in the sales documents, the load capacity is reduced from 160 kg to 125 kg:

2,000 kg technically permissible maximum laden mass

- 1,785 kg actual weighed mass in running order
(in the example: 2% higher than the specified value of 1,750 kg)
- 90 kg ordered optional equipment of the specific vehicle
- = **125 kg actual load capacity**

In order to ensure that the calculated payload is actually adhered to, you should therefore take the possible and permissible tolerances for the mass in running order into account as a precaution when configuring your vehicle.

We also recommend weighing the loaded caravan on a scale before each journey to check whether the technically permissible total weight is adhered to. In addition, we recommend checking the actual drawbar load of the loaded vehicle. This must not be higher than the max. drawbar load of the towing vehicle. Furthermore, the technically permissible maximum laden mass of the vehicle combination must be observed when loaded, i.e. the maximum mass of the combination of your motor vehicle and your caravan.