

# Camper®

## The family caravan

Completely revised with a new, trendy design, the Camper® still remains true to its core values: extensive standard equipment, plenty of storage space and a large selection of bunk bed layouts and short caravans make the Camper® more than ever the ideal caravan for all families hungry for adventure.

## Upholstery



+ Upholstery  
Downtown

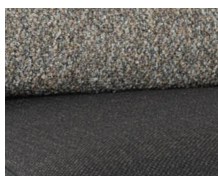

+ Upholstery  
Rooftop ○

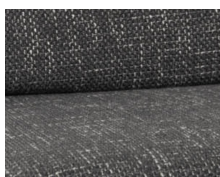

+ City Vibes  
Upholstery ○

## Wood décor



+ Wood décor Noce Nagano

○ optionally available

### Technical info

Overall length, approx.	691 - 942 cm
Overall width, approx.	230 - 250 cm
Overall height, approx.	271 cm
Headroom in living area, approx.	198 cm

Maximum values partly not possible for all models or only in connection with certain options.

## Plus factors

- + Modern style! Stylish, new interior design with accents in trendy green. Upholstery in three matching colour schemes is available for selection.
- + New! Convenient access with the 65 cm wide living room door incl. waste bin.
- + Extra safe: the safelock door interlock with double steel bolts
- + Kitted out for all needs: our portfolio even features short caravans less than 7 m in length
- + Now included as standard: the Dethleffs "SIU System Information Unit" with voltage and level indicator via the Dethleffs app.

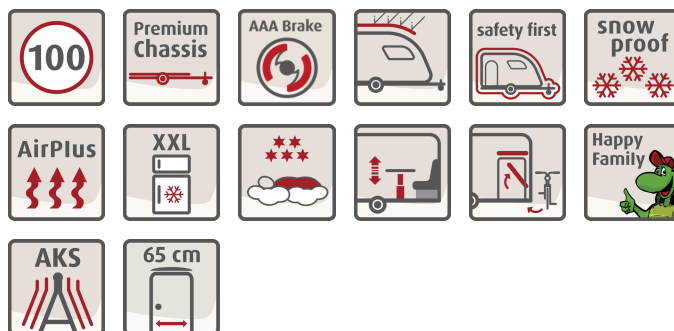

# Camper®

## Technical info



Camper®		460 EL	490 EST	510 LE	520 ELT
Standard chassis		Lightweight chassis, 1500 kg	Lightweight chassis, 1500 kg	Lightweight chassis, 1600 kg	Lightweight chassis, 1700 kg
Overall length, approx.	cm	691	729	762	762
Body length approx.	cm	560	600	640	640
Overall width, approx.	cm	230	230	230	250
Overall height, approx.	cm	271	271	271	271
Circumferential dimension awning approx.	cm	948	988	1028	1028
Headroom in living area, approx.	cm	198	198	198	198
Thickness floor / side walls / roof	mm	42 / 34 / 34	42 / 34 / 34	42 / 34 / 34	42 / 34 / 34
Tire size		185 R14C 8PR	185 R14C 8PR	185 R14C 8PR	195 R14C LI106
Bed dimension: Front bed, L x W, approx.	cm	200 x 85 / 190 x 85 / 190 x 210 ○	200 x 85 / 190 x 85 / 190 x 210 ○	210 x 135	200 x 85 / 190 x 85 / 190 x 210 ○
Bed dimension: Central / middle bed, L X W, approx.	cm	—	185 x 90	—	185 x 90
Bed dimension: Rear bed, L x W, approx.	cm	210 x 115	—	2x 200 x 85 / 200 x 210 ○	—
Sleeping berths standard / max.		3	3	4	3
Mass in running order (+/-5%)*	kg	1220 (1159 to 1281)*	1300 (1235 to 1365)*	1300 (1235 to 1365)*	1455 (1382 to 1528)*
Manufacturer-specified mass for optional equipment*	kg	194	110	196	151
Technically permissible maximum laden mass*	kg	1500	1500	1600	1700
Heating		S 3004, 3.5 kW Gas / Combi 4 G/E, 4 kW Gas-Electric ○	Combi 4 G/E, 4 kW Gas-Electric	S 3004, 3.5 kW Gas / Combi 4 G/E, 4 kW Gas-Electric ○	Combi 6 G/E, 6 kW Gas-Electric / Hot water heating, 6.4 kW Gas-Electric ○
Refrigerator volume (thereof freezer), approx.	l	137 (15)	137 (15)	137 (15)	137 (15)
Waste water tank, approx.	l	22	22	22	22
Fresh water tank capacity, total/ Fresh water tank capacity at driving filling	l	43 / 15	48 / 15	43 / 15	48 / 15
Sockets: 12 V / 230 V / USB		0 / 6 / 1	0 / 6 / 1	0 / 7 / 1	0 / 0 / 1



\* INFO

The specified mass in running order is a standard value defined in the type approval procedure. Due to manufacturing tolerances, the actual weighed mass in running order may deviate from the value stated above. Deviations of up to ± 5% of the mass in running order are legally permissible and possible. The permissible range in kilograms is stated in parentheses after the mass in running order. The mass for optional equipment specified by the manufacturer is an imputed value determined for each type and layout by which Dethleffs specifies the maximum weight available for factory-fitted optional equipment. The purpose of limiting optional equipment is to ensure that the minimum payload, i.e. the legally required free mass for baggage and retrofitted accessories, is actually available for the load capacity of vehicles delivered by

Dethleffs. The actual weight of your vehicle after leaving the factory can only be determined when it is weighed at the end of the line. If, in exceptional cases, the weighing shows that the actual load capacity falls short of the minimum payload due to a permissible weight deviation, despite the limitation of the optional equipment, we will check together with your trading partner and you before delivery of the vehicle whether we should, for example, increase the load capacity of the vehicle or remove optional equipment. The technically permissible maximum laden mass of the vehicle must not be exceeded. For detailed information and explanations on the topic of weight and the configuration of the vehicle, please refer to the "Legal notes" section.

# Camper®

## Technical info

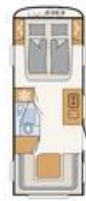

Camper®		530 DR	530 FSK	540 QMK	550 ESK
Standard chassis		Lightweight chassis, 1600 kg	Lightweight chassis, 1600 kg	Lightweight chassis, 1700 kg	Lightweight chassis, 1600 kg
Overall length, approx.	cm	788	788	768	806
Body length approx.	cm	660	660	660	685
Overall width, approx.	cm	230	230	250	230
Overall height, approx.	cm	271	271	271	271
Circumferential dimension awning approx.	cm	1048	1048	1048	1078
Headroom in living area, approx.	cm	198	198	198	198
Thickness floor / side walls / roof	mm	42 / 34 / 34	42 / 34 / 34	42 / 34 / 34	42 / 34 / 34
Tire size		185 R14C 8PR	185 R14C 8PR	195 R14C LI106	185 R14C 8PR
Bed dimension: Front bed, L x W, approx.	cm	205 x 150	200 x 135	200 x 140	2x 200 x 85 / 200 x 210 ○
Bed dimension: Central / middle bed, L X W, approx.	cm	—	190 x 100	230 x 115	190 x 100
Bed dimension: Rear bed, L x W, approx.	cm	210 x 135	210 x 70 / 195 x 75 / 210 x 75 ○ / 210 x 80 ○ / 210 x 70 ○	190 x 75 / 190 x 70 / 2x 190 x 75 ○ / 170 x 75 ○	210 x 70 / 200 x 75 / 210 x 75 ○ / 210 x 80 ○ / 210 x 70 ○
Sleeping berths standard / max.		4	5 / 6 ○	5 / 6 ○	5 / 6 ○
Mass in running order (+/-5%)*	kg	1350 (1283 to 1418)*	1370 (1302 to 1439)*	1460 (1387 to 1533)*	1430 (1359 to 1502)*
Manufacturer-specified mass for optional equipment*	kg	144	104	114	42
Technically permissible maximum laden mass*	kg	1600	1600	1700	1600
Heating		S 5004, 6 kW Gas / Combi 6 G/E, 6 kW Gas-Electric ○ / Hot water heating, 6.4 kW Gas-Electric ○	S 5004, 6 kW Gas / Combi 6 G/E, 6 kW Gas-Electric ○ / Hot water heating, 6.4 kW Gas-Electric ○	S 5004, 6 kW Gas / Combi 6 G/E, 6 kW Gas-Electric ○ / Hot water heating, 6.4 kW Gas-Electric ○	S 5004, 6 kW Gas / Combi 6 G/E, 6 kW Gas- Electric ○ / Hot water heating, 6.4 kW Gas- Electric ○
Refrigerator volume (thereof freezer), approx.	l	137 (15)	137 (15)	137 (15)	137 (15)
Waste water tank, approx.	l	22	22	22	22
Fresh water tank capacity, total/ Fresh water tank capacity at driving filling	l	43 / 15	43 / 15	43 / 15	43 / 15
Sockets: 12 V / 230 V / USB		0 / 9 / 1	0 / 7 / 3	0 / 8 / 3	0 / 8 / 3



\* INFO

The specified mass in running order is a standard value defined in the type approval procedure. Due to manufacturing tolerances, the actual weighed mass in running order may deviate from the value stated above. Deviations of up to ± 5% of the mass in running order are legally permissible and possible. The permissible range in kilograms is stated in parentheses after the mass in running order. The mass for optional equipment specified by the manufacturer is an imputed value determined for each type and layout by which Dethleffs specifies the maximum weight available for factory-fitted optional equipment. The purpose of limiting optional equipment is to ensure that the minimum payload, i.e. the legally required free mass for baggage and retrofitted accessories, is actually available for the load capacity of vehicles delivered by

Dethleffs. The actual weight of your vehicle after leaving the factory can only be determined when it is weighed at the end of the line. If, in exceptional cases, the weighing shows that the actual load capacity falls short of the minimum payload due to a permissible weight deviation, despite the limitation of the optional equipment, we will check together with your trading partner and you before delivery of the vehicle whether we should, for example, increase the load capacity of the vehicle or remove optional equipment. The technically permissible maximum laden mass of the vehicle must not be exceeded. For detailed information and explanations on the topic of weight and the configuration of the vehicle, please refer to the "Legal notes" section.

# Camper®

## Technical info

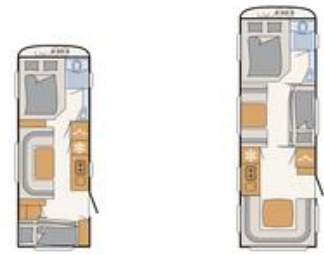

Camper®		560 FMK	730 FKR
Standard chassis		Lightweight chassis, 1700 kg	Lightweight chassis, 2000 kg
Overall length, approx.	cm	818	942
Body length approx.	cm	685	815
Overall width, approx.	cm	250	250
Overall height, approx.	cm	271	271
Circumferential dimension awning approx.	cm	1078	1208
Headroom in living area, approx.	cm	198	198
Thickness floor / side walls / roof	mm	42 / 34 / 34	42 / 34 / 34
Tire size		195 R14C LI106	185/70 R14 LI88
Bed dimension: Front bed, L x W, approx.	cm	200 x 155	200 x 155
Bed dimension: Central / middle bed, L X W, approx.	cm	230 x 115	200 x 75 / 2x 195 x 75 / 2x 195 x 75 ○
Bed dimension: Rear bed, L x W, approx.	cm	195 x 70 / 190 x 75 / 195 x 75 ○ / 195 x 80 ○ / 195 x 70 ○	230 x 155
Sleeping berths standard / max.		5 / 6 ○	7 / 8 ○
Mass in running order (+/-5%)*	kg	1530 (1454 to 1607)*	1800 (1710 to 1890)*
Manufacturer-specified mass for optional equipment*	kg	42	39
Technically permissible maximum laden mass*	kg	1700	2000
Heating		S 5004, 6 kW Gas / Combi 6 G/E, 6 kW Gas-Electric ○ / Hot water heating, 6.4 kW Gas-Electric ○	S 5004, 6 kW Gas / Combi 6 G/E, 6 kW Gas-Electric ○ / Hot water heating, 6.4 kW Gas-Electric ○
Refrigerator volume (thereof freezer), approx.	l	137 (15)	137 (15)
Waste water tank, approx.	l	22	22
Fresh water tank capacity, total/ Fresh water tank capacity at driving filling	l	43 / 15	43 / 15
Sockets: 12 V / 230 V / USB		0 / 9 / 3	0 / 10 / 3

○ Optional equipment — Not possible ● Standard equipment ◆ Mandatory △ Not known at the time of publication



The specified mass in running order is a standard value defined in the type approval procedure. Due to manufacturing tolerances, the actual weighed mass in running order may deviate from the value stated above. Deviations of up to ± 5% of the mass in running order are legally permissible and possible. The permissible range in kilograms is stated in parentheses after the mass in running order. The mass for optional equipment specified by the manufacturer is an imputed value determined for each type and layout by which Dethleffs specifies the maximum weight available for factory-fitted optional equipment. The purpose of limiting optional equipment is to ensure that the minimum payload, i.e. the legally required free mass for baggage and retrofitted accessories, is actually available for the load capacity of vehicles delivered by

Dethleffs. The actual weight of your vehicle after leaving the factory can only be determined when it is weighed at the end of the line. If, in exceptional cases, the weighing shows that the actual load capacity falls short of the minimum payload due to a permissible weight deviation, despite the limitation of the optional equipment, we will check together with your trading partner and you before delivery of the vehicle whether we should, for example, increase the load capacity of the vehicle or remove optional equipment. The technically permissible maximum laden mass of the vehicle must not be exceeded. For detailed information and explanations on the topic of weight and the configuration of the vehicle, please refer to the "Legal notes" section.

# Standard equipment

	460 EL	490 EST	510 LE	520 ELT	530 DR	530 FSK	540 QMK	550 ESK	560 FMK	730 FKR
<b>Chassis</b>										
Single axle premium wheel 195 R14 C LI106 (with steel wheel 1.700 kg and 1.800 kg)	—	—	—	●	—	—	●	—	●	—
Tyres on steel wheels 185 R14 C 8 PR, up to and including 1.600 kg	●	●	●	—	●	●	—	●	—	—
Tyres on steel wheels 185/70 R14 LI88 up to and including 2.000 kg	—	—	—	—	—	—	—	—	—	●
Zinc-plated chassis with inertia braking system with reversing automatic	●	●	●	●	●	●	●	●	●	●
<b>Chassis features</b>										
AAA self-adjusting brake	●	●	●	●	●	●	●	●	●	●
ACS stabiliser	●	●	●	●	●	●	●	●	●	●
High-quality brand-name tyres, designed for a speed of 100 km/h	●	●	●	●	●	●	●	●	●	●
Lightweight corner steadies	●	●	●	●	●	●	●	●	●	●
Octagon shock absorber	●	●	●	●	●	●	●	●	●	●
<b>Exterior features</b>										
Floor of the gas bottle locker made of rot-resistant and robust corrugated aluminium	●	●	●	●	●	●	●	●	●	●
Flyscreen door	●	●	●	●	●	●	●	●	●	●
Front parts in gas locker area made of LFI (long fiber injection) technology, shock resistant, robust and repair-friendly	●	●	●	●	●	●	●	●	●	●
Fully-insulated wheel houses	●	●	●	●	●	●	●	●	●	●
Kitchen window, sliding (change of window shape)	●	●	—	—	●	●	—	●	●	—
Midi Heki lift-and-tilt skylight incl. illuminated roof lining	●	●	●	●	●	●	●	●	●	●
Opening window in bathroom	—	●	—	—	—	●	●	—	●	●
Opening windows, trapezoid, insulated and double-glazed (graphite grey) with blackout and mosquito blinds	●	●	●	●	●	●	●	●	●	●
Robust GRP roof	●	●	●	●	●	●	●	●	●	●
Sidewall skirts with integrated side-marker lamps	●	●	●	●	●	●	●	●	●	●
Skylight Mini Heki	●	●	●	●	●	●	●	●	●	●
Space-saving gas locker door which opens upwards	●	●	●	●	●	●	●	●	●	●
Spare wheel carrier in gas locker	●	●	●	●	●	●	●	●	●	●
Storage space for 2 gas bottles with 11 kg filling weight each	●	●	●	●	●	●	●	●	●	●
Wide, one-piece habitation door	●	●	●	●	●	●	●	●	●	●
<b>Exterior design</b>										
Front and rear in smooth sides white	●	●	●	●	●	●	●	●	●	●
Sides in hammer finish, white	●	●	●	●	●	●	●	●	●	●
<b>Access locker doors</b>										
Access locker door front right side 648x348 mm	—	—	—	—	●	—	—	—	—	—
Access locker door front right side 997x419 mm	●	●	—	●	—	●	—	●	—	—
Access locker door rear right side 997x419 mm	—	—	●	—	—	—	—	—	—	—
<b>Interior design</b>										
Upholstery Downtown	●	●	●	●	●	●	●	●	●	●
Wood décor Noce Nagano	●	●	●	●	●	●	●	●	●	●
<b>Textile equipment</b>										
7-zones double bed mattress, made of heat-regulating material	—	—	—	—	●	●	●	—	●	●
7-zones mattress left side, made of heat-regulating material	●	●	●	●	—	—	—	●	—	—
7-zones mattress right side, made of heat-regulating material	●	●	●	●	—	—	—	●	—	—
Additional cushion for bed construction	●	●	●	●	●	●	●	●	●	●
<b>Furniture layouts</b>										
AirPlus - perfect air circulation in the interior and rear ventilation of the overhead lockers and sideboards	●	●	●	●	●	●	●	●	●	●
Bunk bed with 2 sleeping berths, foldable	—	—	—	—	—	●	●	●	●	—
Bunk bed with 2 sleeping berths, not foldable	—	—	—	—	—	—	—	—	—	●
Bunk beds with safety net and ladder	—	—	—	—	—	●	●	●	●	●
One-legged telescopic table, height adjustable	—	—	—	●	●	—	●	—	●	●
Seating lounge converts to bed	●	●	●	●	●	●	●	●	●	●
Special slatted frame with flexible natural rubber holders, opening for optimal use of storage compartments under the beds	●	●	●	●	●	●	●	●	●	●

# Standard equipment

	460 EL	490 EST	510 LE	520 ELT	530 DR	530 FSK	540 QMK	550 ESK	560 FMK	730 FKR
<b>Kitchen</b>										
Generous drawers with soft closing for absolutely silent closing	●	●	●	●	●	●	●	●	●	●
High-quality 2-burner hob with electric ignition	●	●	●	●	●	●	●	●	●	●
Large fridge with 137 liters capacity and 15 liters freezer compartment	●	●	●	●	●	●	●	●	●	●
Practical apothecary drawers (depending on layout)	●	●	●	●	●	●	●	●	●	●
<b>Bathroom</b>										
Integrated design washbasin made of solid surface material	●	●	●	●	●	●	●	●	●	●
Shower tray	●	●	●	●	●	●	●	●	●	●
Skylight with mosquito net	●	●	●	●	●	●	●	●	●	●
<b>Heating</b>										
Gas heating S 3004 with automatic ignition	●	—	●	—	—	—	—	—	—	—
Gas heating S 5004 with automatic ignition	—	—	—	—	●	●	●	●	●	●
Hot air system	●	●	●	●	●	●	●	●	●	●
<b>Electrical installation</b>										
12 V power supply throughout vehicle	●	●	●	●	●	●	●	●	●	●
Awning light 12V	●	●	●	●	●	●	●	●	●	●
CEE external output socket for 230V on-board electrics	●	●	●	●	●	●	●	●	●	●
Compact power distribution unit with 230V safety device and 12V fuse box in wardrobe incl. powerful 340W transformer	●	●	●	●	●	●	●	●	●	●
Indirect lighting (roof level)	●	●	●	●	●	●	●	●	●	●
LED light bar system 12V (on head-side of bed and in seating lounge)	●	●	●	●	●	●	●	●	●	●
USB port for spotlight bar	●	●	●	●	●	●	●	●	●	●
<b>Water supply</b>										
Electric water supply	●	●	●	●	●	●	●	●	●	●
Fresh water tank 38 l	●	●	●	●	●	●	●	●	●	●
Hot water supply	●	—	●	—	●	●	●	●	●	●
Mobile 22 l waste water tank	●	●	●	●	●	●	●	●	●	●
<b>Miscellaneous</b>										
Dethleffs Connect - System Information Unit: SIU control unit incl. voltage and levelling display via the Dethleffs app.	●	●	●	●	●	●	●	●	●	●

# Packages Camper®

Package	Styling Package white (single axle) (13254)	Styling Package white (single axle) (13254)	Styling Package white (single axle) (13254)
Smooth sides white	x		
17" alloy wheels in Dethleffs design (single axle)	x	x	x
Draw bar cover	x	x	x
Large support feet, 4 pc.	x	x	x
Solid rubber support wheel with support load indicator	x	x	x
Rear light carrier with high attachment and roof rails	x	x	x
Front moulding with high attachment and roof rails	x	x	x
Smooth sides white		x	
Smooth sides white			x
Additional weight (kg)*	45.7	48.3	51.1

Package	Styling Package white (tandem axle) (13256)	Styling Package white (tandem axle 2.8 t) (13258)
17" alloy wheels in Dethleffs design (tandem axle)	x	
Draw bar cover	x	x
Large support feet, 4 pc.	x	x
Solid rubber support wheel with support load indicator	x	x
Rear light carrier with high attachment and roof rails	x	x
Front moulding with high attachment and roof rails	x	x
Smooth sides white	x	x
Tyres on alloy wheels 195/70 R14 C LI104, 2200 kg to 2800 kg		x
Additional weight (kg)*	43.4	47.4

Package	Styling Package silver (single axle) (13255)	Styling Package silver (single axle) (13255)	Styling Package silver (single axle) (13255)
Smooth sides titanium silver metallic	x		
17" alloy wheels in Dethleffs design (single axle)	x	x	x
Draw bar cover	x	x	x
Large support feet, 4 pc.	x	x	x
Solid rubber support wheel with support load indicator	x	x	x
Rear light carrier with high attachment and roof rails	x	x	x
Front moulding with high attachment and roof rails	x	x	x
Smooth sides titanium silver metallic		x	
Smooth sides titanium silver metallic			x
Additional weight (kg)*	45.7	48.3	51.1



\* INFO

The factory installation of optional equipment increases the actual mass of the vehicle and reduces the payload. The specified additional weight for packages and optional equipment shows the additional weight compared with the standard equipment of the respective model or layout. The total weight of the selected optional equipment must not exceed the mass for optional equipment specified by the manufacturer in the model overviews. This is an imputed

value determined for each model and layout that Dethleffs uses to determine the maximum weight available for factory-installed optional equipment. In the event of an increase of load capacity, the mass for optional equipment specified by the manufacturer is increased. For detailed information and explanations on the topic of weight, please refer to the "Legal notes" section.

Package	Styling Package silver (tandem axle) (13257)	Styling Package silver (tandem axle 2.8 t) (13259)
17" alloy wheels in Dethleffs design (tandem axle)	x	
Draw bar cover	x	x
Large support feet, 4 pc.	x	x
Solid rubber support wheel with support load indicator	x	x
Rear light carrier with high attachment and roof rails	x	x
Front moulding with high attachment and roof rails	x	x
Smooth sides titanium silver metallic	x	x
Tyres on alloy wheels 195/70 R14 C LI104, 2200 kg to 2800 kg		x
Additional weight (kg)*	43.4	47.4

Package	Winter Comfort Package for Combi heating (10481)
Electric floor heating	x
XPS insulation for front, rear and sides (depending on vehicle size)	x
Insulated threader hose	x
Additional weight (kg)*	30.1

Package	Winter Comfort Package Combi 6 (9536)	Winter Comfort Package Combi 6 (9536)	Winter Comfort Package Combi 6 (9536)
Electric floor heating	x	x	x
Waste water pipes insulated and heated	x	x	x
Insulated threader hose	x	x	x
XPS insulation for front, rear and sides (depending on vehicle size)	x		
Hot air heating Combi 6 G/E incl. digital control unit	x	x	x
XPS insulation for front, rear and sides (depending on vehicle size)		x	
XPS insulation for front, rear and sides (depending on vehicle size)			x
Additional weight (kg)*	50.1	52.8	55

Package	Winter Comfort Package SNOW (5459)	Winter Comfort Package SNOW (5459)	Winter Comfort Package SNOW (5459)
Hot water heating	x	x	x
Electric floor heating	x	x	x
Waste water pipes insulated and heated	x	x	x
XPS insulation for front, rear and sides (depending on vehicle size)	x		
XPS insulation for front, rear and sides (depending on vehicle size)		x	
XPS insulation for front, rear and sides (depending on vehicle size)			x
Additional weight (kg)*	74.1	76.8	79



\* INFO

The factory installation of optional equipment increases the actual mass of the vehicle and reduces the payload. The specified additional weight for packages and optional equipment shows the additional weight compared with the standard equipment of the respective model or layout. The total weight of the selected optional equipment must not exceed the mass for optional equipment specified by the manufacturer in the model overviews. This is an imputed

value determined for each model and layout that Dethleffs uses to determine the maximum weight available for factory-installed optional equipment. In the event of an increase of load capacity, the mass for optional equipment specified by the manufacturer is increased. For detailed information and explanations on the topic of weight, please refer to the "Legal notes" section.



Package	Winter Comfort Package SNOW PLUS (5551)	Winter Comfort Package SNOW PLUS (5551)	Winter Comfort Package SNOW PLUS (5551)
Hot water heating	x	x	x
Hot water floor heating (only in comb. with option 205)	x	x	x
Waste water pipes insulated and heated	x	x	x
XPS insulation for front, rear and sides (depending on vehicle size)	x		
XPS insulation for front, rear and sides (depending on vehicle size)		x	
XPS insulation for front, rear and sides (depending on vehicle size)			x
Additional weight (kg)*	75.1	77.8	80

Package	Mover Autonomy Package (single axle) (5560)	Mover Autonomy Package (tandem axle) (5561)
Mover manoeuvring support for single-axle	x	
Electric Autonomy equipment	x	x
Mover manoeuvring support for tandem-axle		x
Additional weight (kg)*	70	98

Package	Water and Electric Autonomy Package Combi 4 (11031)	Water and Electric Autonomy Package Combi 6 (11032)	Water & Electric Autonomy Package with Combi or hot water heating system (9943)
Hot air heating Combi 4 G/E incl. digital control unit	x		
Electric Autonomy equipment	x	x	x
Fresh water tank 70 l	x	x	x
Hot air heating Combi 6 G/E incl. digital control unit		x	
Additional weight (kg)*	55.5	55.5	40.5

Safety Package (8950)	
ATC Trailer Control	
DuoControl safety gas pressure regulator with crash sensor and EisEx gas regulator heater	
Smoke detector	
Additional weight (kg)*	7

Shower Package (6105)	
Shower equipment with shower fittings and curtain	
City water connection	
Additional weight (kg)*	7

△ Not known at the time of publication



\* INFO

The factory installation of optional equipment increases the actual mass of the vehicle and reduces the payload. The specified additional weight for packages and optional equipment shows the additional weight compared with the standard equipment of the respective model or layout. The total weight of the selected optional equipment must not exceed the mass for optional equipment specified by the manufacturer in the model overviews. This is an imputed

value determined for each model and layout that Dethleffs uses to determine the maximum weight available for factory-installed optional equipment. In the event of an increase of load capacity, the mass for optional equipment specified by the manufacturer is increased. For detailed information and explanations on the topic of weight, please refer to the "Legal notes" section.

## Optional equipment\*

	Included in package	Additional weight (kg)*	Code	460 EL	490 EST	510 LE	520 ELT	530 DR	530 FSK	540 QMK	550 ESK	560 FMK	730 FKR
<b>Chassis</b>													
17" alloy wheels in Dethleffs design (single axle)	STP	10	11608	○	○	○	○	○	○	○	○	○	—
17" alloy wheels in Dethleffs design (tandem axle)	STP	0	11609	—	—	—	—	—	—	—	—	—	○
Tyres on alloy wheels 185 R14 C LI102, up to and including 1600 kg	—	0	836	○	○	○	—	○	○	—	○	—	—
Tyres on alloy wheels 185/70 R14 LI88, up to and including 2000 kg	—	0	840	—	—	—	—	—	—	—	—	—	○
Tyres on alloy wheels 195 R14 C LI106, 1700 kg and 1800 kg	—	2	838	○	○	○	○	○	○	○	○	○	—
Tyres on alloy wheels 195/70 R14 C LI104, 2200 kg to 2800 kg	STP	4	859	—	—	—	—	—	—	—	—	—	○
<b>Weight upgrade</b>													
Weight upgrade 1.600 kg	—	22.8	322	○	—	—	—	—	—	—	—	—	—
Weight upgrade 1.600 kg	—	23.6	322	—	○	—	—	—	—	—	—	—	—
Weight upgrade 1.700 kg (incl. steel wheel 195 R14 C LI106)	—	0.3	278	—	—	—	—	○	○	—	○	—	—
Weight upgrade 1.700 kg (incl. steel wheel 195 R14 C LI106)	—	23.1	278	○	—	—	—	—	—	—	—	—	—
Weight upgrade 1.700 kg (incl. steel wheel 195 R14 C LI106)	—	23.9	278	—	○	—	—	—	—	—	—	—	—
Weight upgrade 1.700 kg (incl. steel wheel 195 R14 C LI106)	—	24.3	278	—	—	○	—	—	—	—	—	—	—
Weight upgrade 1.800 kg (incl. steel wheel 195 R14 C LI106)	—	5.9	279	—	—	—	—	—	—	○	—	—	—
Weight upgrade 1.800 kg (incl. steel wheel 195 R14 C LI106)	—	6.6	279	—	—	—	—	—	—	—	—	○	—
Weight upgrade 1.800 kg (incl. steel wheel 195 R14 C LI106)	—	6.8	279	—	—	—	—	○	○	—	○	—	—
Weight upgrade 1.800 kg (incl. steel wheel 195 R14 C LI106)	—	31.6	279	—	○	—	○	—	—	—	—	—	—
Weight upgrade 1.800 kg (incl. steel wheel 195 R14 C LI106)	—	32	279	—	—	○	—	—	—	—	—	—	—
Weight upgrade 1.900 kg (incl. alloy wheel 225/70 R15 C LI112)	—	27	394	—	—	—	○	—	—	—	—	—	—
Weight upgrade 1.900 kg (incl. alloy wheel 225/70 R15 C LI112)	—	18.7	394	—	—	—	—	—	—	—	—	○	—
Weight upgrade 1.900 kg (incl. alloy wheel 225/70 R15 C LI112)	—	23.8	394	—	—	—	—	—	—	○	—	—	—
Weight upgrade 1.900 kg (incl. alloy wheel 225/70 R15 C LI112)	—	19.2	394	—	—	—	—	○	○	—	○	—	—
Weight upgrade 2.000 kg (incl. alloy wheel 225/70 R15 C LI112)	—	18.7	138	—	—	—	—	—	—	—	—	○	—
Weight upgrade 2.000 kg (incl. alloy wheel 225/70 R15 C LI112)	—	19.2	138	—	—	—	—	○	○	—	○	—	—
Weight upgrade 2.000 kg (incl. alloy wheel 225/70 R15 C LI112)	—	23.8	138	—	—	—	—	—	—	○	—	—	—
Weight upgrade 2.000 kg (incl. alloy wheel 225/70 R15 C LI112)	—	27	138	—	—	—	○	—	—	—	—	—	—
Weight upgrade 2.200 kg (incl. steel wheel 195/70 R14 C LI104)	—	2.6	6351	—	—	—	—	—	—	—	—	—	○
Weight upgrade 2.500 kg (incl. steel wheel 195/70 R14 C LI104)	—	2.6	496	—	—	—	—	—	—	—	—	—	○
Weight upgrade 2.800 kg (incl. steel wheel 195/70 R14 C LI104)	—	27.4	7713	—	—	—	—	—	—	—	—	—	○
<b>Chassis features</b>													
ATC Trailer Control	SHF	4	748	○	○	○	○	○	○	○	○	○	○
Breakdown kit	—	1	620	○	○	○	○	○	○	○	○	○	○
Draw bar cover	STP	2	434	○	○	○	○	○	○	○	○	○	○
Large support feet, 4 pc.	STP	1	6348	○	○	○	○	○	○	○	○	○	○
Mover manoeuvring support for single-axle <sup>8)</sup>	M-P	32	946	○	○	○	○	○	○	○	○	○	—
Mover manoeuvring support for tandem-axle <sup>8)</sup>	M-P	60	984	—	—	—	—	—	—	—	—	—	○
Solid rubber support wheel with support load indicator	STP	2	10063	○	○	○	○	○	○	○	○	○	○
Spare tyre with alloy wheel 185 R14 C LI 102, up to and including 1.600 kg	—	17	837	○	○	○	—	○	—	—	—	—	—
Spare tyre with alloy wheel 185/70 R14 LI 88, up to and including 2.000 kg	—	18	841	—	—	—	—	—	—	—	—	—	○
Spare tyre with alloy wheel 195 R14 C 8PR-LI 106, 1.700 kg and 1.800 kg	—	19	839	○	○	○	○	○	—	—	—	○	—
Spare tyre with alloy wheel 195/70 R14 C-LI 102, 2.200 kg to 2.800 kg	—	19	861	—	—	—	—	—	—	—	—	—	○



### \* INFO

The factory installation of optional equipment increases the actual mass of the vehicle and reduces the payload. The specified additional weight for packages and optional equipment shows the additional weight compared with the standard equipment of the respective model or layout. The total weight of the selected optional equipment must not exceed the mass for optional equipment specified by the manufacturer in the model overviews. This is an imputed

value determined for each model and layout that Dethleffs uses to determine the maximum weight available for factory-installed optional equipment. In the event of an increase of load capacity, the mass for optional equipment specified by the manufacturer is increased. For detailed information and explanations on the topic of weight, please refer to the "Legal notes" section.

## Optional equipment\*

	Included in package	Additional weight (kg)*	Code	460 EL	490 EST	510 LE	520 ELT	530 DR	530 FSK	540 QMK	550 ESK	560 FMK	730 FKR
Spare tyre with alloy wheel 225/70 R15 C LI 112 , 1.900 kg and 2.000 kg	—	23.5	1092	—	—	—	○	—	—	—	—	○	—
Spare tyre with steel wheel 185 R14 C 8 PR, up to and including 1.600 kg	—	18	831	○	○	○	—	○	—	—	—	—	—
Spare tyre with steel wheel 185/70 R14 LI 88, up to and including 2.000 kg	—	18	835	—	—	—	—	—	—	—	—	—	○
Spare tyre with steel wheel 195 R14 C LI 106, 1.700 kg and 1.800 kg	—	19.5	833	○	○	○	○	○	—	—	—	○	—
Spare tyre with steel wheel 195/70 R14 C-LI 104, 2.200 kg to 2.800 kg	—	20	860	—	—	—	—	—	—	—	—	—	○
Wheel trims for 14" tyres	—	2	276	○	○	○	○	○	○	○	○	○	○
<b>Exterior features</b>													
Flush-fitting windows (not possible for front and rear windows) <sup>9)</sup>	—	3	7561	○	○	○	○	○	○	○	○	○	○
Front window	—	4	982	○	○	●	○	○	—	○	○	—	—
Front window (bed area), if washroom in front	—	5	855	—	—	—	—	—	○	—	—	○	○
Manual cassette awning, 3.75 m	—	25.5	13831	○	—	—	—	—	—	—	—	—	—
Manual cassette awning, 4 m	—	27.5	13832	—	○	○	○	—	—	—	—	—	—
Manual cassette awning, 4.5 m	—	30	13833	—	—	—	—	○	○	○	○	○	—
Manual cassette awning, 6 m	—	54.6	13835	—	—	—	—	—	—	—	—	—	○
Rear window	—	4	1108	●	—	○	—	●	—	—	—	—	●
Wide, one-piece habitation door with window	—	3	862	○	○	○	○	○	○	○	○	○	○
XPS insulation for front, rear and sides (depending on vehicle size)	—	17.6	179	○	—	—	—	—	—	—	—	—	—
XPS insulation for front, rear and sides (depending on vehicle size)	WI-KO	20.1	179	—	○	○	○	○	○	○	—	—	—
XPS insulation for front, rear and sides (depending on vehicle size)	WI-KO	22.8	179	—	—	—	—	—	—	—	○	○	—
XPS insulation for front, rear and sides (depending on vehicle size)	WI-KO	25	179	—	—	—	—	—	—	—	—	—	○
<b>Exterior design</b>													
Front moulding with high attachment and roof rails	STP	1	627	○	○	○	○	○	○	○	○	○	○
Rear light carrier with high attachment and roof rails	STP	11	624	○	○	○	○	○	○	○	○	○	○
Smooth sides titanium silver metallic	STP	18.7	659	○	—	—	—	—	—	—	—	—	—
Smooth sides titanium silver metallic	STP	21.3	659	—	○	○	○	○	○	○	—	—	—
Smooth sides titanium silver metallic	STP	24.1	659	—	—	—	—	—	—	—	○	○	—
Smooth sides titanium silver metallic	STP	26.4	659	—	—	—	—	—	—	—	—	—	○
Smooth sides white	STP	18.7	443	○	—	—	—	—	—	—	—	—	—
Smooth sides white	STP	21.3	443	—	○	○	○	○	○	○	—	—	—
Smooth sides white	STP	24.1	443	—	—	—	—	—	—	—	○	○	—
Smooth sides white	STP	26.4	443	—	—	—	—	—	—	—	—	—	○
<b>Access locker doors</b>													
Access locker door 1550x1050 mm with window	—	8	9486	—	—	—	—	—	—	○	—	—	—
Access locker door front left 997x419 mm	—	2.2	1079	—	—	—	○	—	—	●	○	●	●
Access locker door front left side 1069x299 mm	—	2	1083	—	—	○	—	—	—	—	—	—	—
Access locker door front left side 648x348 mm	—	2	1071	—	—	—	○	○	—	—	○	—	—
Access locker door front right side 1069x299 mm	—	2	1084	—	—	○	—	—	—	—	—	—	—
Access locker door rear left side 1069x299 mm	—	2	1085	—	—	—	—	—	—	—	—	—	○
Access locker door rear left side 749x297 mm	—	2	1077	○	—	—	—	—	—	—	—	—	—
Access locker door rear right side 1069x299 mm	—	2	1086	—	—	—	—	○	—	—	—	—	○
<b>Interior design</b>													
City Vibes Upholstery	—	0	13792	○	○	○	○	○	○	○	○	○	○
Upholstery Rooftop	—	0	13791	○	○	○	○	○	○	○	○	○	○



\* INFO

The factory installation of optional equipment increases the actual mass of the vehicle and reduces the payload. The specified additional weight for packages and optional equipment shows the additional weight compared with the standard equipment of the respective model or layout. The total weight of the selected optional equipment must not exceed the mass for optional equipment specified by the manufacturer in the model overviews. This is an imputed

value determined for each model and layout that Dethleffs uses to determine the maximum weight available for factory-installed optional equipment. In the event of an increase of load capacity, the mass for optional equipment specified by the manufacturer is increased. For detailed information and explanations on the topic of weight, please refer to the "Legal notes" section.

## Optional equipment\*

	Included in package	Additional weight (kg)*	Code	460 EL	490 EST	510 LE	520 ELT	530 DR	530 FSK	540 QMK	550 ESK	560 FMK	730 FKR
<b>Textile equipment</b>													
7-zones double bed mattress, made of heat-regulating material with watergel cover	—	4	8214	—	—	—	—	○	○	○	—	○	○
7-zones mattress left side, made of heat-regulating material with watergel cover	—	2	8215	○	○	○	○	—	—	—	○	—	—
7-zones mattress right side, made of heat-regulating material with watergel cover	—	5	8216	○	○	○	○	—	—	—	○	—	—
Loose carpet	—	8.5	513	○	○	○	○	○	○	○	○	○	○
<b>Furniture layouts</b>													
Bunk bed with 2 sleeping berths, not foldable, instead of seating lounge	—	0	9775	—	—	—	—	—	—	—	—	—	○
Bunk bed with 3 sleeping berths, not foldable	—	20	200	—	—	—	—	—	○	○	○	○	—
Single beds convert to double bed	—	5	685	○	○	○	○	—	—	—	○	—	—
Slatted bed frame with adjustable head section	—	1	871	○	○	○	○	—	—	—	○	—	—
<b>Interior features</b>													
2 kg fire extinguisher	—	3.5	843	○	○	○	○	○	○	○	○	○	○
Multifunctional tray 2 pieces	—	1	15003	○	○	○	○	○	○	○	○	○	○
Smoke detector	SHP	0.5	8949	○	○	○	○	○	○	○	○	○	○
<b>Kitchen</b>													
Oven	—	17	572	○	○	○	○	○	○	○	○	○	○
<b>Bathroom</b>													
Bathroom in alternative design	—	4	604	—	—	—	—	—	○	○	—	○	○
<b>Multimedia</b>													
Flat screen TV 22" incl. DVD player and receiver <sup>10)</sup>	—	3.5	1103	○	○	○	○	○	○	○	○	○	○
Multifunctional external connection, 12 V, 220 V, TV and SAT	—	1	611	○	○	○	○	○	○	○	○	○	○
Preparation for flat screen TV (antenna cable and TV bracket)	—	2	678	○	○	○	○	○	○	○	○	○	○
<b>Heating</b>													
Electric floor heating	WI-KO	9	387	○	○	○	○	○	○	○	○	○	○
Fan 12 V with automatic speed control for S 5004	—	2	178	—	—	—	—	○	○	○	○	○	○
Fan 12V for S 3004	—	2	177	○	—	○	—	—	—	—	—	—	—
Hot air heating Combi 4 G/E incl. digital control unit	WEA-P	15	10480	○	●	○	—	—	—	—	—	—	—
Hot air heating Combi 6 G/E incl. digital control unit	WEA-P, WI-KO	15	9427	—	—	—	●	○	○	○	○	○	○
Hot water floor heating (only in comb. with option 205) <sup>11)</sup>	WI-KO	10	674	—	—	—	○	○	○	○	○	○	○
Hot water heating	WI-KO	40	205	—	—	—	○	○	○	○	○	○	○
Insulated threader hose <sup>12)</sup>	WI-KO	1	9535	○	○	○	○	○	○	○	○	○	○
Ultraheat additional heating for S 3004, electric 220 V	—	2	364	○	—	○	—	—	—	—	—	—	—
Ultraheat additional heating for S 5004, electric 220 V	—	2	422	—	—	—	—	○	○	○	○	○	○
<b>Air Conditioning</b>													
Pre-wiring for A/C	—	0	172	○	○	○	○	○	○	○	○	○	○
Roof A/C	—	35	8145	○	○	○	○	○	○	○	○	○	○
<b>Electrical installation</b>													
Electric Autonomy equipment	WEA-P, M-P	38	492	○	○	○	○	○	○	○	○	○	○



### \* INFO

The factory installation of optional equipment increases the actual mass of the vehicle and reduces the payload. The specified additional weight for packages and optional equipment shows the additional weight compared with the standard equipment of the respective model or layout. The total weight of the selected optional equipment must not exceed the mass for optional equipment specified by the manufacturer in the model overviews. This is an imputed

value determined for each model and layout that Dethleffs uses to determine the maximum weight available for factory-installed optional equipment. In the event of an increase of load capacity, the mass for optional equipment specified by the manufacturer is increased. For detailed information and explanations on the topic of weight, please refer to the "Legal notes" section.

## Optional equipment\*

	Included in package	Additional weight (kg)*	Code	460 EL	490 EST	510 LE	520 ELT	530 DR	530 FSK	540 QMK	550 ESK	560 FMK	730 FKR
<b>Water supply</b>													
City water connection	DUP	2	414	○	○	○	○	○	○	○	○	○	○
Exterior shower	—	2	396	○	○	○	○	○	○	○	○	○	○
Fresh water tank 70 l	WEA-P	2.5	592	○	○	○	○	○	○	○	○	○	○
Shower equipment with shower fittings and curtain	DUP	5	1097	○	○	○	○	○	○	○	○	○	○
Waste water pipes insulated and heated	WI-KO	5	520	—	—	—	○	○	○	○	○	○	○
<b>Gas supply</b>													
DuoControl safety gas pressure regulator with crash sensor and EisEx gas regulator heater	SHP	2.5	784	○	○	○	○	○	○	○	○	○	○
Gas socket (exterior)	—	1	187	○	○	○	○	○	○	○	○	○	○
<b>Packages</b>													
Mover Autonomy Package (single axle)	—	70	5560	○	○	○	○	○	○	○	○	○	—
Mover Autonomy Package (tandem axle)	—	98	5561	—	—	—	—	—	—	—	—	—	○
Safety Package	—	7	8950	○	○	○	○	○	○	○	○	○	○
Shower Package	—	7	6105	○	○	○	○	○	○	○	○	○	○
Styling Package silver (single axle)	—	51.1	13255	—	—	—	—	—	—	—	○	○	—
Styling Package silver (single axle)	—	48.3	13255	—	○	○	○	○	○	○	—	—	—
Styling Package silver (single axle)	—	45.7	13255	○	—	—	—	—	—	—	—	—	—
Styling Package silver (tandem axle 2.8 t)	—	47.4	13259	—	—	—	—	—	—	—	—	—	○
Styling Package silver (tandem axle)	—	43.4	13257	—	—	—	—	—	—	—	—	—	○
Styling Package white (single axle)	—	45.7	13254	○	—	—	—	—	—	—	—	—	—
Styling Package white (single axle)	—	48.3	13254	—	○	○	○	○	○	○	—	—	—
Styling Package white (single axle)	—	51.1	13254	—	—	—	—	—	—	—	○	○	—
Styling Package white (tandem axle 2.8 t)	—	47.4	13258	—	—	—	—	—	—	—	—	—	○
Styling Package white (tandem axle)	—	43.4	13256	—	—	—	—	—	—	—	—	—	○
Water & Electric Autonomy Package with Combi or hot water heating system	—	40.5	9943	○	○	○	○	○	○	○	○	○	○
Water and Electric Autonomy Package Combi 4	—	55.5	11031	○	—	○	—	—	—	—	—	—	—
Water and Electric Autonomy Package Combi 6	—	55.5	11032	—	—	—	—	○	○	○	○	○	○
Winter Comfort Package Combi 6	—	55	9536	—	—	—	—	—	—	—	—	—	○
Winter Comfort Package Combi 6	—	52.8	9536	—	—	—	—	—	—	—	○	○	—
Winter Comfort Package Combi 6	—	50.1	9536	—	—	—	—	○	○	○	—	—	—
Winter Comfort Package SNOW	—	74.1	5459	—	—	—	○	○	○	○	—	—	—
Winter Comfort Package SNOW	—	76.8	5459	—	—	—	—	—	—	—	○	○	—
Winter Comfort Package SNOW	—	79	5459	—	—	—	—	—	—	—	—	—	○
Winter Comfort Package SNOW PLUS	—	77.8	5551	—	—	—	—	—	—	—	○	○	—
Winter Comfort Package SNOW PLUS	—	80	5551	—	—	—	—	—	—	—	—	—	○
Winter Comfort Package SNOW PLUS	—	75.1	5551	—	—	—	○	○	○	○	—	—	—
Winter Comfort Package for Combi heating	—	30.1	10481	—	—	—	○	—	—	—	—	—	—
<b>Miscellaneous</b>													
Registration documents (CoC papers)	—	0	15151	◆	◆	◆	◆	◆	◆	◆	◆	◆	◆

○ Optional equipment   — Not possible   ● Standard equipment   ◆ Mandatory   △ Not known at the time of publication

STP Styling Package   SHP Safety Package   M-P Mover Autonomy Package   WI-KO Winter Comfort Package   WEA-P Water and Electric Autonomy Package   DUP Shower Package



\* INFO

The factory installation of optional equipment increases the actual mass of the vehicle and reduces the payload. The specified additional weight for packages and optional equipment shows the additional weight compared with the standard equipment of the respective model or layout. The total weight of the selected optional equipment must not exceed the mass for optional equipment specified by the manufacturer in the model overviews. This is an imputed

value determined for each model and layout that Dethleffs uses to determine the maximum weight available for factory-installed optional equipment. In the event of an increase of load capacity, the mass for optional equipment specified by the manufacturer is increased. For detailed information and explanations on the topic of weight, please refer to the "Legal notes" section.

# LEGAL NOTES ON WEIGHT-RELATED INFORMATION

The weight specifications and tests for caravans are regulated uniformly throughout the EU in EU Implementing Regulation No. 2021/535 (until June 2022: EU Regulation No. 1230/2012). We have summarized and explained the essential terminology and legal requirements from this regulation for you below. Our dealers and the Dethleffs configurator on our website are there to give you additional assistance in configuring your vehicle.

## 1. Technically permissible maximum laden mass

The **technically permissible maximum laden mass** of the vehicle (e.g. 2,000 kg) is a mass specification defined by the manufacturer that the vehicle must not exceed. You can find information on the technically permissible maximum laden mass of the model you have selected in the technical data. Driving the vehicle even if it exceeds the technically permissible maximum laden mass constitutes an administrative offense that may result in a fine.

## 2. Mass in running order

In simple terms, the mass in running order is the basic vehicle with standard equipment. This essentially includes the following items:

- the unladen weight of the vehicle together with the bodywork, including operating fluids;
- the standard equipment, i.e. all equipment and standard fittings included when the vehicle leaves the factory;
- the 100% filled water tank or drinking tank according to the manufacturer's specifications and a 100% filled aluminum gas cylinder.

You can find information on the mass in running order for each model in our sales documents. It is **important to note** that the value specified in the sales documents for the mass in running order is a **standard value** determined in the type approval process and verified by the authorities. It is legally permissible and possible for the mass in running order of the vehicle delivered to you to deviate from the nominal value specified in the sales documents. The **legally permissible tolerance** is  $\pm 5\%$ . This allows EU legislation to account for the occurrence of certain fluctuations in the mass in running order due to weight fluctuations in components supplied by third-party suppliers as well as process and weather-related factors.

These weight deviations can be illustrated using the following example calculation:

- Mass in running order according to sales documents: 1,600 kg
- Legally permissible tolerance of  $\pm 5\%$ : 80 kg
- Legally permissible range of mass in running order: 1,520 kg to 1,680 kg

The specific range of permissible weight deviations can be found in the technical data for each model.

Dethleffs makes great efforts to reduce weight variations to the minimum level that is unavoidable for production reasons. Deviations at the upper and lower ends of the range are therefore very rare; however, they cannot be completely ruled out technically, even after carrying out all possible optimization measures. For this reason, Dethleffs checks the actual weight of the vehicle and compliance with the permissible tolerance by weighing each vehicle at the end of the line.

## 3. Optional equipment and actual mass

According to the legal definition, optional equipment (also including special or additional equipment) includes all optional equipment parts not included with the standard equipment that are fitted to the vehicle under the responsibility of the manufacturer – i.e. at the factory – and can be ordered by the customer (e.g. awning, smooth panel, Alde heating system, oven, etc.). For information on the individual or package weights of the optional equipment that can be ordered, please refer to our sales documents. In this meaning, optional equipment does not include other accessories that are retrofitted by you or your dealer personally after the vehicle has been delivered from the factory.

The mass of the vehicle in running order (see no. 2 above) and the mass of the optional equipment installed on a specific vehicle at the factory are together referred to as the actual mass. You will find the corresponding information for your vehicle after handover under item 13.2 of the Certificate of Conformity (CoC). Please note that this information also represents a standardized value. Since the mass in running order – as an element of the actual mass – is subject to a legally permissible tolerance of  $\pm 5\%$  (see no. 2), the actual mass may also deviate accordingly from the specified nominal value.

## 4. Payload and minimum payload

The installation of **optional equipment** is also subject to technical and legal limits: It is only permissible to order an amount of optional equipment for installation at the factory that will leave sufficient free weight for baggage and other accessories (i.e. "payload") without exceeding the technically permissible maximum laden mass.

The payload is obtained by deducting the mass in running order (nominal value according to sales documents; see no. 2 above) and the mass of the optional equipment from the technically permissible maximum laden mass (see no. 1 above). The EU regulations stipulate a fixed minimum payload for caravans that must remain as a minimum for baggage or other accessories not installed at the factory. This minimum payload is calculated as follows:

Minimum payload in kg  $\geq 10 \cdot (n + L)$

where "n" = maximum number of sleeping berths and

"L" = total length of the vehicle body (without drawbar).

The maximum number of sleeping berths corresponds to the actual configured sleeping berths of the individual vehicle. For a caravan with 6 designated sleeping berths and a total length of the vehicle body of 7 m, the minimum payload is calculated as follows:  $10 \text{ kg} \cdot (6 + 7) = 130 \text{ kg}$ .

To ensure that the minimum payload is maintained, there is a maximum combination of optional equipment that can be ordered for each vehicle model. In the above example with a minimum payload of 130 kg, the total mass of the optional equipment for a vehicle with 6 designated sleeping berths and a mass in running order of 1,750 kg should not exceed 120 kg:

**2,000 kg technically permissible maximum laden mass**

- 1,750 kg mass in running order
- 130 kg minimum payload
- = **120 kg maximum permissible mass for optional equipment**

**It is important to note** that this calculation is based on the standard value for the mass in running order specified in the type approval procedure and does not account for permissible weight deviations for the mass in running order (see no. 2 above). If the maximum permissible value of 120 kg for the optional equipment is nearly or fully exhausted in this example and the standard value of the mass in running order is applied, it is possible for the minimum payload of 130 kg to be complied with mathematically in the event of an upward weight deviation even if the vehicle has no load capacity.

Here is another example calculation for a vehicle with 6 sleeping berths whose actual weighed mass in running order is 2% above the nominal value:

**2,000 kg technically permissible maximum laden mass**

- 1,785 kg actual weighed mass in running order  
(in the example: 2% higher than the specified value of 1,750 kg)
- 120 kg optional equipment (maximum permissible value)
- = **95 kg actual load capacity**  
( $<$  minimum pay-mass of 130 kg)

To avoid such a situation, Dethleffs further reduces the maximum permissible weight of the total optional equipment that can be ordered depending on the specific model. The limitation of optional equipment is intended to ensure that the minimum payload, i.e. the legally prescribed free mass for baggage and retrofitted accessories, is actually available for the load capacity of the vehicles delivered by Dethleffs.

Since the weight of a specific vehicle can only be determined when it is weighed at the end of the line, in very rare cases a situation may arise in which the minimum payload is not guaranteed at the end of the line despite this limitation of optional equipment. In order to guarantee the minimum payload even in these cases, Dethleffs will check together with your trading partner and you before delivery of the vehicle whether, for example, the load capacity of your vehicle is to be increased or optional equipment removed.

## **5. Effects of tolerances of the mass in running order on the remaining load capacity**

Irrespective of the minimum payload, you should bear in mind that unavoidable production-related fluctuations in the mass in running order – both upwards and downwards – have a corresponding effect on the remaining load capacity: If, for example, you order our example vehicle with optional equipment with a total weight of 90 kg, the calculated payload based on the standard value for the mass in running order is 160 kg.

The load capacity actually available may deviate upwards or downwards from this value due to tolerances. If the mass of your vehicle in running order is approximately 2% higher than specified in the sales documents, the load capacity is reduced from 160 kg to 125 kg:

**2,000 kg technically permissible maximum laden mass**

- 1,785 kg actual weighed mass in running order  
(in the example: 2% higher than the specified value of 1,750 kg)
- 90 kg ordered optional equipment of the specific vehicle
- = **125 kg actual load capacity**

In order to ensure that the calculated payload is actually adhered to, you should therefore take the possible and permissible tolerances for the mass in running order into account as a precaution when configuring your vehicle.

We also recommend weighing the loaded caravan on a scale before each journey to check whether the technically permissible total weight is adhered to. In addition, we recommend checking the actual drawbar load of the loaded vehicle. This must not be higher than the max. drawbar load of the towing vehicle. Furthermore, the technically permissible maximum laden mass of the vehicle combination must be observed when loaded, i.e. the maximum mass of the combination of your motor vehicle and your caravan.